

Foldable Wireless keyboard User Manual

Compatible System
Win /iOS /Android/Mac
Note: Please read the user manual carefully before you start using this product

Product Overview

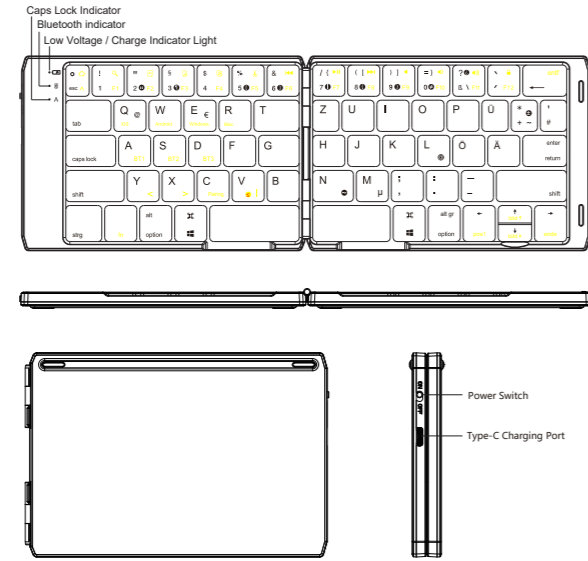

Bluetooth Connection (Take BT1 for example)

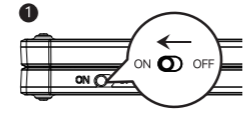

1. Set up the power switch to "ON".



2. Press the fn+BT1 Bluetooth key to switch channels. When the Bluetooth indicator lights on, indicates your channel has switched into BT1.



2. Press fn+C pairing mode.

Note: You can repeat above steps if you switch to BT2/BT3.

Windows System (Bluetooth Connection)

4. Click the "Bluetooth Devices" on your computer.

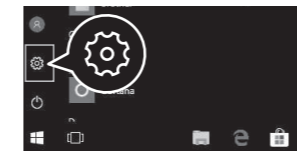

5. "Click "Add or delete bluetooth devices".

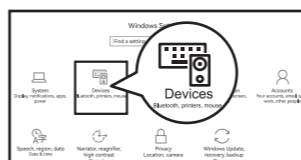

6. Find "NB-DF007BG", click pair.

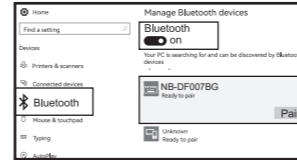

7. "NB-DF007BG" shows connected, you can use the keyboard now.



iOS System (Bluetooth Connection)

Please complete Bluetooth Connection steps 1 2 3 and switch your keyboard into Bluetooth Mode before pairing.

4. Go to Settings and turn Bluetooth on.

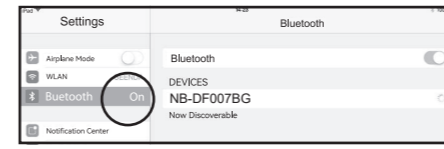

5. "Search for "NB-DF007BG" and Click "Pair", pairing successfully.

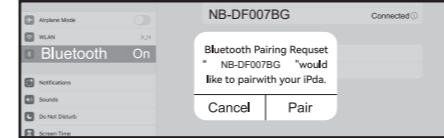

6. The keyboard connected successfully.

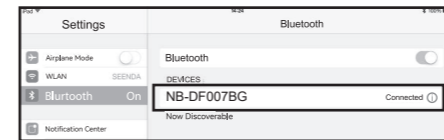

Android System (Bluetooth Connection)

Please complete Bluetooth Connection steps 1 2 3 and switch your keyboard into Bluetooth Mode before pairing.

4. Click "Settings" and turn on "Bluetooth".

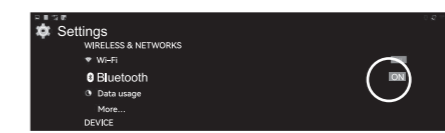

5. Find "NB-DF007BG", click "pair"

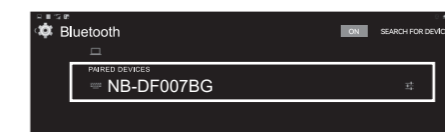

6. "NB-DF007BG" shows "connected", you can start using the keyboard.



Product Function

iOS/Android/Mac		Windows		Windows	
Fn+	Corresponding function	Fn+Shift+	Corresponding function	Fn+	Corresponding function
	Return to Desk		Home Page		F1
	Search		Search		F2
	Select		Select		F3
	Copy		Copy		F4
	Stick		Stick		F5
	Cut		Cut		F6
	Previous		Previous		F7
	Play/Pause		Play/Pause		F8
	Next Track		Next Track		F9
	Mute		Mute		F10
	Volume-		Volume-		F11
	Volume+		Volume+		F12
	lock		lock		

iOS System

Alt +	Corresponding function	FN +	Corresponding function
			<
			>

Win / Android / Mac System

Press directly	Corresponding function	Shift+	Corresponding function
	esc		
	1		!
	2		''
	3		\$
	4		%
	5		%
	6		&
	7		/
	8		(
	9)
	0		=
	ß		?
	/		\

Three system switching languages

iOS/Mac : control+Space key
Windows : Alt+Shift
Android : control+Space key / Shift+Space key

Three system input method switch

iOS/Mac : control+ Space key Windows : control+ Shift
Android : control+ Shift

Technical Specifications

Keyboard size: 295 X 101 X 8.8 mm (open)
150 X 101 X 17.1 mm (folding)
Weight: 187 g Key working current: <3.5 mA
Working distance: 10 m Standby current: < 0.3 mA
Lithium battery capacity: 90 mAh Sleep current: 5 µA
Working voltage: 3.7 V Sleep time: Ten minutes
Charger specifications: 5V --- 1A or 2A Awaken way : Press key

Status Display LED

- Connect : Press the fn+BT1 Bluetooth key to switch channels. When the Bluetooth indicator lights on, indicates your channel has switched into BT1. Press fn+C pairing mode.
- Charging : Red Indicator light will be on , after fully charging, the light crush out.
- Low Voltage Indication : When the voltage is below 3.2 V, red light twinkles.
- CAPSLOCK light: Press CAPSLOCK and the blue light will remain on.

Multi-channel connection

- Before connecting the first device, press Fn+BT1 to switch channels, and then hold down Fn+ C pairing mode.
- Before connecting the second device, press Fn+BT2 to switch channels, and then hold down Fn+ C pairing mode.
- Before connecting the third device, press Fn+BT3 to switch channels, and then hold down Fn+ C pairing mode.
- To use multiple devices at the same time, press Fn + BT1 / BT2 / BT3 to switch to the connected devices freely .

Troubleshooting

Please contact the after-sales service.

Copyright

It is forbidden to reproduce any part of this manual without the permission of seller.

Safety instructions

Do not open or repair this device, Do not use the device in a damp environment. Clean the device with a dry cloth.

Warranty

The device is provided with one-year limited hardware warranty from the purchase day.

Keyboard Maintenance

- Please keep the keyboard away from liquid or humid environment, saunas, swimming pool, steam room and don't let the keyboard get wet in the rain.
- Please don't expose the keyboard at too high or too low temperature condition.
- Please don't put keyboard under sun for a long time.
- Please don't put keyboard close to the flame, such as cooking stoves, candles or fireplace.
- Avoid sharp objects scratching products, timely to recharge products to ensure the normal use.

FAQ

- The tablet PC can't connect the BT keyboard?
1) At first check the BT keyboard is into match code state, then open the table PC Bluetooth searching.
- Checking the BT keyboard Battery is enough, the battery low is also lead to can't connect, you need charge.
- The keyboard indication light always flashing when use?
Keyboard indication always flashing when use, is means the keyboard will be no power, please charge the power as soon as possible.
- The table PC display BT keyboard is disconnect?
The Bluetooth keyboard is not used for a period of time, the device will automatically enter the sleep state in order to save power. Press any key on the keyboard to wake up, and the Bluetooth connection will be automatically restored.

CE DECLARATION OF COMPLIANCE

Date: 22-10-2025
Company Name: Shenzhen DZH Industrial Co., Ltd
Address: 3rdFloor, Yituo Mike Industrial A building, Bu Yong Industrial D zone, Shajing street, Baoan district, Shenzhen, China
Manufacturer: Shenzhen DZH Industrial Co., LTD
Address: 3th Floor, DZH Industrial A building, Bu Yong Industrial D zone, Shajing, Baoan, Shenzhen, China
Product Description: Foldable Wireless Keyboard
Model No./Type Ref.: DF007

We confirm that the designated product corresponds to the substantial requirements of the following European guidelines:

No.	Part No./Reference No.	Result	standards:
1	LVD	Compliant	Conformity EN IEC 62368-1:2020+A11:2020
2	EMC	Compliant	ETSI EN 301 489-17 V3.2.4(2020-09) ETSI EN 301 489-3 V2.3.2 (2023-01) ETSI EN 301 489-1 V2.2.3 (2019-11)
3	RoHS	Compliant	ROHS-2011/65/EU,2015/863/EU REACH-(EC)No.1907/2006
4	WEEE	Compliant	WEEE-2012/19/EU
5	Reach	Compliant	REACH-(EC)No.1907/2006